

TOILET ROLL HOLDER AC220



150 x 92 x 44 mm

- Toilet roll holder in solid, germ-reducing and easy-care stainless steel (AISI 303), satin finished. Further available surfaces: see below.
- Designed for one standard toilet roll with dimensions:
 - Outer diameter max. 125 mm
 - Width max. 100 mm
 - Core diameter min. 38 mm
- Concealed anti-theft two-point rosette wall mounting.
- Holder diameter 16 mm
- Width 150 mm
- Mounting with two screws.
- Delivery includes fixing material.
- Weight, including single package: 0.4 kg



Suggested text for specifications:

Toilet roll holder in solid stainless steel (AISI 303), satin finished, for surface mounting. Concealed anti-theft two-point rosette wall mounting. Delivery includes fixing material.

Dimensions: 150 x 92 x 44 mm

Article No. AC220

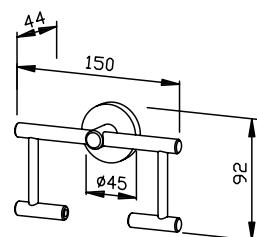

Available surfaces	ID No.
satin finished (standard)	700 220
highly polished	731 220

Ernst Wagner GmbH & Co. KG

Ernst-Abbe-Straße 21 · D-72770 Reutlingen · Tel.: +49712151539-0 · Fax: -20
info@wagner-ewar.de · www.wagner-ewar.de

WAGNER
E W A R